

BP5P-C700-100.1

100 W CONSTANT CURRENT LED DRIVER

Features

- Constant current type power supply
- Power Factor Correction
- 100 – 240 VAC input
- IP67 protection class
- UL1310 Class 2 power unit, pass LPS
- 100% full load burn-in tested
- Designed for LED lighting and signage applications
- 5 years warranty

Conformity & Standards

- EN60950-1
- EN61347-2-13
- EN55015
- EN55022 Class B
- EN 61000-3-2,-3
- EN61000-4-2,3,4,5,6,8,11
- EN50204
- EN55024
- EN61547



Technical information

General specifications

| | |
|----------------------|---|
| Efficiency | 90% |
| Turn on delay | 0.8 s |
| Operating conditions | -30 °C ~ +50 °C; 20 ~ 90% humidity |
| Storage conditions | -40 °C ~ +80 °C; 10 ~ 95% humidity |
| IP class | IP67 |
| Protections included | Over current Short circuit Over voltage Over temperature |
| Warranty | 5 years, 45 000 h |

Quantity of drivers per circuit breaker

| Circuit breaker of type B | Circuit breaker of type C |
|---------------------------|---------------------------|
| 4 units (at 230 VAC) | 8 units (at 230 VAC) |

Dimensions

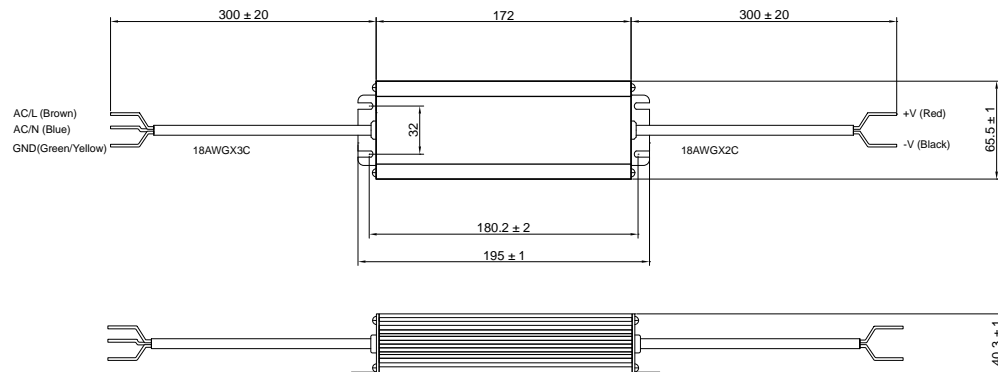

Input

| | |
|----------------------|-----------------------------|
| Input voltage range | 100 – 240 VAC; (47 – 63 Hz) |
| Max input AC current | 0.7 A |
| Max inrush current | 65 A |
| Power factor | 0.95 |

Output

| | |
|----------------|--------------|
| Max load | 142 VDC |
| Output current | 0.7 A ± 5% |
| Output voltage | 85 – 142 VDC |
| Output power | 99.4 |

Ordering information

| SKU | Unit net weight, g | Unit dimensions, mm |
|-----------------|--------------------|---------------------|
| BP5P-C700-100.1 | 900.0 | 195 x 65.5 x 40.3 |